

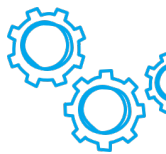

Economy *Power-D-Box*®

The Economy *Power-D-Box*® is a compact power distribution system with only 2 height units (HU). The redundantly designed system accommodates 8335 or 8340-F magnetic hydraulic-magnetic plug-in type circuit breakers. The busbars as well as the group signalisation are insulated in a moulded enclosure, so that live parts cannot be touched. Connection of loads is from the front via blade terminals which are protected against reverse polarity. Besides various preferred types, we can offer individual solutions, perfectly tailored to your application.



TYPICAL FEATURES

- 19" power distribution system, made of aluminium
- Voltage rating DC 48 V, 65 V, 80 V
- Minus-pole protected
- Load up to 25 A per circuit breaker (30 A upon request)
- Integrated cable strain relief
- Optional accessories: load output connectors protected against reverse polarity, extracting tool, blind cover

YOUR BENEFITS

- Compact and service-friendly design
- Easy mounting in 19" and ETSI system cabinets by means of reversible flanges
- Reliable alarm management by means of group signalling
- Easy system extension during operation thanks to plug-in type circuit protectors
- Redundant power supply ensures unrivalled system uptime

PREFERRED TYPES

Preferred types are E-T-A products, which are most frequently used by our customers. We manufacture these preferred types in substantial quantities. [You can find an overview of our preferred types here \(Page 3\).](#)

TYPICAL APPLICATIONS

Telecommunications and datacom, network infrastructures

COMPLIANCE



WEB LINKS

[Further information](#), [Installation instruction](#), [REACH](#), [RoHS](#), [Contact](#)

GENERAL INFORMATION

FURTHER INFORMATION



Installation instruction
https://www.e-t-a.de/19bgtx8340_s02.pdf

TECHNICAL DATA

ELECTRICAL DATA

Rated voltage U_n	DC 48 V; DC 65 V; DC 80 V
Protected pole	1-pole minus
Circuit breakers / circuit protectors	8340-F (8340-F410-P1xx-KNH0-xxA) plug-in type circuit breaker
Number of loads	depending on version, 2 x 4, 2 x 6, 2 x 8
Redundancy	Redundant system
Fire resistance (IEC 60695, section 2-2)	Self-extinguishing

MECHANICAL DATA

Mounting dimensions (WxHxD)	Width: 482.6 mm (19" mounting) x Height: 89 mm (2 HU) x Installation depth: 288 mm
Mass	Approx. 1.5 kg
Material	Aluminium
Enclosure grounding	2 x M6 for enclosure
Cable strain relief	Integrated

SUPPLY

Total current per supply	Max. 132 A per supply at -30...+60 °C ambient temperature
Terminals / Cable cross section	Screw terminals 6...50 mm ² , flexible without wire end ferrule 6...35 mm ² , flexible with wire end ferrule

LOADS

Rated current per load channel	Max. 25 A (30 A upon request)
Terminals / Cable cross section	Reverse polarity protected DIN 46244-A (6.3 x 0.8 mm) blade terminal Load channels at the front: 0.7...6.0 mm ²

GROUP SIGNALLING

Parallel connection	DIN 46244-A blade terminals 4.8 x 0.8 mm
---------------------	---------------------------------------------

AMBIENT CONDITIONS

Ambient temperature	-30...+60 °C
---------------------	--------------

ORDERING NUMBER CODE



1 TYPE NUMBER

PDB *Power-D-Box*® 19" (condition as delivered), with ETSI reversible flange – 19"

2 PROTECTED POLE

N Minus pole protected

3 2

S2 X8340-S02L/R...-103

4 LOAD CHANNELS

xx Number of load channels (total)

Looking for a customer-specific version you cannot find in our ordering number code? Please get in touch with us. Circuit protectors are not included in the delivery scope.

PREFERRED TYPES

Preferred types	Short description
PDB-N-S2 08	Load current max. 132 A with 2 x 4 front-side load terminals
PDB-N-S2 12	Load current max. 132 A with 2 x 6 front-side load terminals
PDB-N-S2 16	Load current max. 132 A with 2 x 8 front-side load terminals

COMPLIANCE

According to 2014/35/EU (EN62368-1) and 2011/65/EU



DIMENSIONS

DIMENSIONAL DRAWING PDB-N-S2

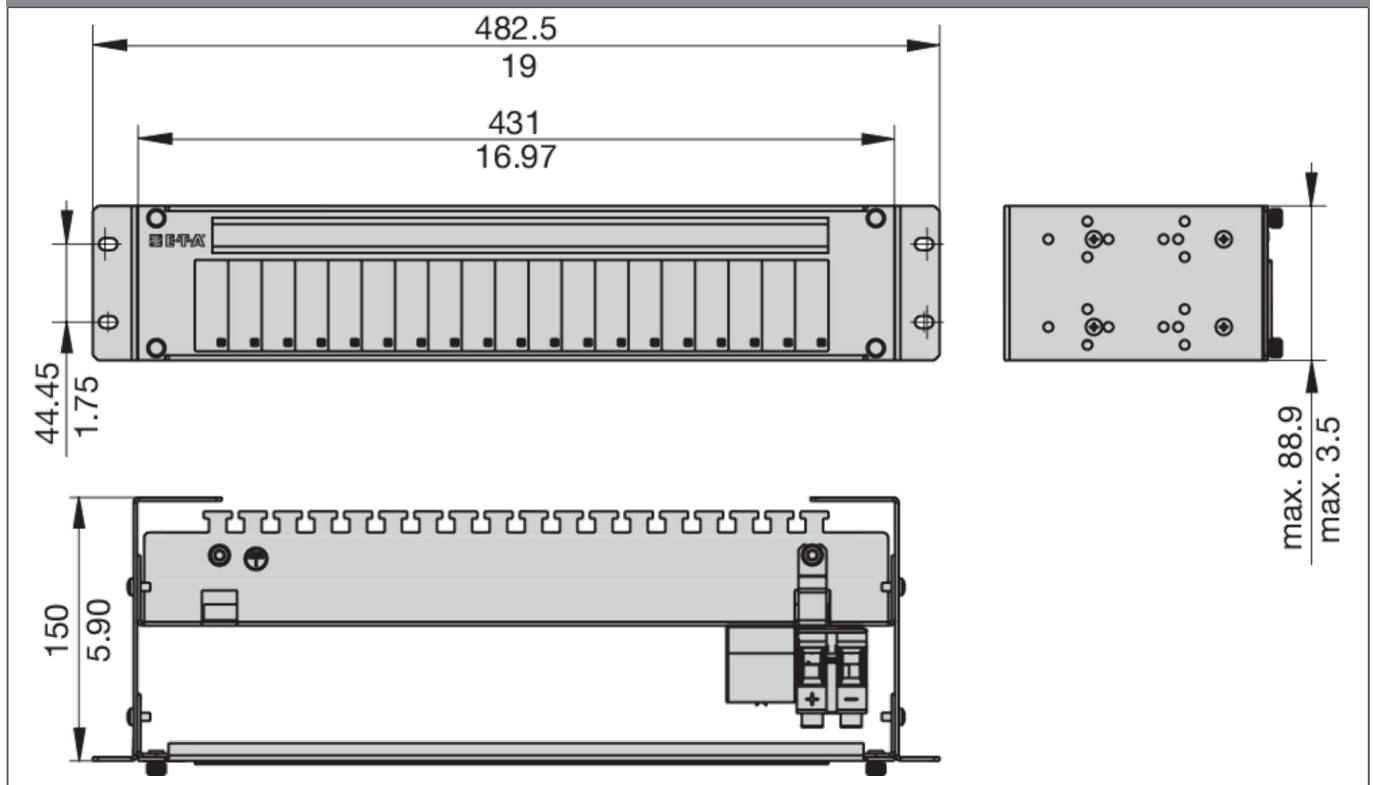

SCHEMATIC DIAGRAMS

PDB-N-S2 SCHEMATIC DIAGRAM

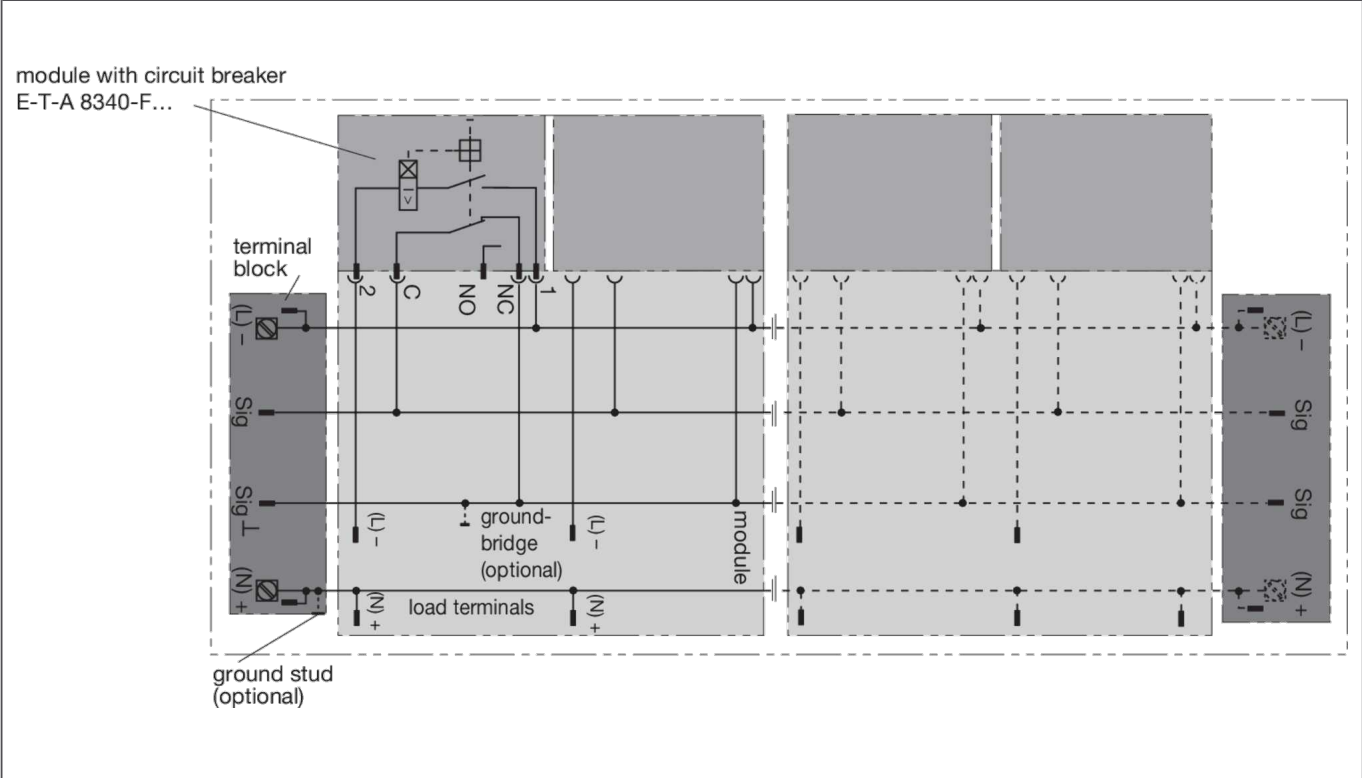

ACCESSORIES

REQUIRED ACCESSORIES

False polar. set Load terminal	(Set: 4 plastic sleeves, 8 blade terminals 6.3 x 0.8 mm)
	Ordering no. key: X22284701 for cable cross section 0.7...2.0 mm ²
	Ordering no. key: X22262501 for cable cross section 2.5...4.0 mm ²
	Ordering no. key: X22284801 for cable cross section 4.0...6.0 mm ²

OPTIONAL ACCESSORIES

X22254711	Removing bracket (Device versions 8340-F)
Y30856311	Blind cover for Power-D-Box® (Device versions 8340/8345)

FURTHER INFORMATION ABOUT ACCESSORIES (DRAWINGS)

ACCESSORIES

Load output terminal protected against reverse polarity
(set: 4 moulded sleeves, 8 blade terminals 6.3 x 0.8 mm)

X 222 847 01 for cable cross section 0.7...2.0 mm²
X 222 625 01 for cable cross section 2.5...4.0 mm²
X 222 848 01 for cable cross section 4.0...6.0 mm²

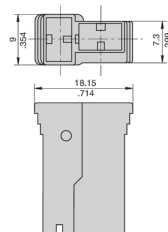

ACCESSORIES

Blanking piece for Power-D-Box
(circuit breaker types 8340, 8345)
Y 308 563 11

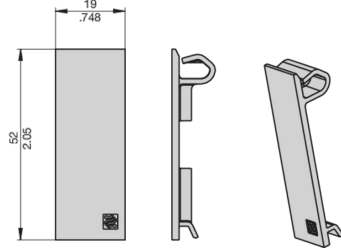

For removing the blanking piece:
push in the screwdriver as shown below

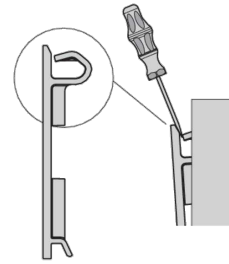

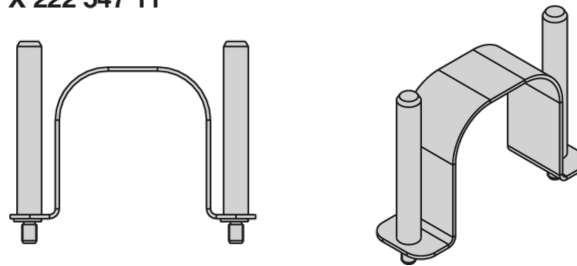

ACCESSORIES

Withdrawal tool
(circuit breaker types 8340-F)
X 222 547 11



FURTHER PRODUCTS

RELATED PRODUCTS

<p><u>8335 (EN 60934 / UL 1077)</u></p>	<p>Single and multipole circuit breaker with magnetic or hydraulic-magnetic trip curve. Toggle actuation, front panel mounting, various trip characteristics and optionally available auxiliary contacts. The precise switching mechanism ensures reliable disconnection through an independent trip-free mechanism even at lowest overcurrents. Low temperature sensitivity at rated load.</p> <p>Complies with the IEC/EN 60934 S-type, HM standard for circuit breakers for equipment protection.</p>	
<p><u>8335 (EN 60934 / UL 489A)</u></p>	<p>Single and multipole circuit breaker with magnetic or hydraulic-magnetic trip curve. Toggle actuation, front panel mounting, various trip characteristics and optionally available auxiliary contacts. The precise switching mechanism ensures reliable disconnection through an independent trip-free mechanism even at lowest overcurrents. Low temperature sensitivity at rated load.</p> <p>Complies with the IEC/EN 60934 S-type, HM standard for circuit breakers for equipment protection.</p>	
<p><u>8340-F</u></p>	<p>Single and multipole circuit breaker with magnetic or hydraulic-magnetic trip curve. Toggle actuation, front panel mounting, various trip characteristics and optionally available auxiliary contacts. The precise switching mechanism ensures reliable disconnection through an independent trip-free mechanism even with the smallest overcurrents. Low temperature sensitivity at rated load. Meets the requirements of the circuit breaker standard EN 60934 (IEC 60934): S-type, HM or MO</p>	

All information and data given on our products are accurate and reliable to the best of our knowledge, but E-T-A does not accept any responsibility for the use in applications which are not in accordance with the present specification. E-T-A reserves the right to change specifications at any time in the interest of technical improvement. Dimensions are subject to change without notice. Please enquire for the latest dimensional drawing with tolerances if required. All dimensions, data, pictures and descriptions are for information only and are not binding. Amendments, errors and omissions excepted. Ordering part numbers may differ from the device marking.